



Series 200 - 3:1 - 5.30 gpm



Applied
Lubrication
Technology Inc.

Air-operated pumps for short and medium distance distribution.
Ideal for transferring low/medium-viscosity fluids such as: waste oils (filtered), lubricants, antifreeze and diesel fuel. The wall-mount version of these pumps is also available with special accessories and/or extensions for specific applications (see page 58 and 64).

COMPATIBLE FLUIDS (page 16)

- MO** Low and medium viscosity fluids
- WO** Waste fluids
- AD** Antifreeze, diesel fuel



P/N 35061-55

P/N 35076-55

P/N 35094-55

Type of seals	Viton®
Air motor	aluminum
Suction tube	carbon steel
Bung adapter	38046-55
Air inlet connection	1/4" NPT (f)
Fluid outlet connection	1/2" NPT (f)
Air working pressure	90 - 120 psi
Noise level	81 dB
Deliverable oil temperature	14 - 122 °F
Max. deliverable oil viscosity	130 SAE
Cycles per gallon	60.4
Max. air consumption 120 psi	23 cfm
Suction tube length	7.2" (excluded P/N 10/20-55)
Suction tube external diameter	1.26"
Type of installations	modular - customizable 1"
Packaging - Weight	No. 1 0.35 ft³ lb 8

Type of seals	Viton®
Air motor	aluminum
Suction tube	carbon steel
Bung adapter	38046-55
Air inlet connection	1/4" NPT (f)
Fluid outlet connection	1/2" NPT (f)
Air working pressure	90 - 120 psi
Noise level	81 dB
Deliverable oil temperature	14 - 122 °F
Max. deliverable oil viscosity	130 SAE
Cycles per gallon	60.4
Max. air consumption 120 psi	23 cfm
Suction tube length	29"
Suction tube external diameter	1.26"
Type of installations	suitable for drum 16 gal
Packaging - Weight	No. 1 0.60 ft³ lb 9

Type of seals	Viton®
Air motor	aluminum
Suction tube	carbon steel
Bung adapter	38046-55
Air inlet connection	1/4" NPT (f)
Fluid outlet connection	1/2" NPT (f)
Air working pressure	90 - 120 psi
Noise level	81 dB
Deliverable oil temperature	14 - 122 °F
Max. deliverable oil viscosity	130 SAE
Cycles per gallon	60.4
Max. air consumption 120 psi	23 cfm
Suction tube length	37"
Suction tube external diameter	1.26"
Type of installations	suitable for drum 55 gal
Packaging - Weight	No. 1 0.60 ft³ lb 14

TYPE OF INSTALLATIONS

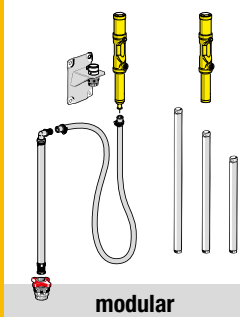

modular

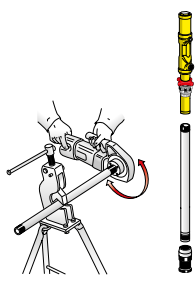

customizable 1"

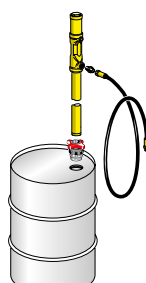

with drum

PUMP PERFORMANCE

- A** 116 psi
- B** 87 psi
- C** 58 psi

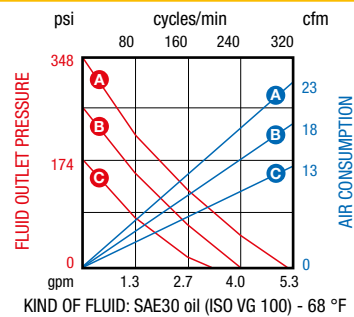



Series 238 - 3:1 - 4.40 gpm

Series 238 air-operated pumps for medium-distance oil distribution.

Ideal for distributing
medium viscosity oils.
Suitable for movable
installations and fixed
systems.

The wall-mount version
of these pumps is also
available with special
accessories and/or
extensions for specific
applications (see
page 58 and 64).

COMPATIBLE FLUIDS (page 16)



Low and medium
viscosity fluids



P/N 35561-55

P/N 35564-55

P/N 35567-55

Type of seals	NBR
Air motor	aluminum
Suction tube	carbon steel
Bung adapter	38042-55
Air inlet connection	1/4" NPT (f)
Fluid outlet connection	1/2" NPT (f)
Air working pressure	90 - 120 psi
Noise level	81 dB
Deliverable oil temperature	14 - 122 °F
Max. deliverable oil viscosity	130 SAE
Cycles per gallon	102.3
Max. air consumption 120 psi	26 cfm
Suction tube length	10.7" (excluded P/N 10/20-55)
Suction tube external diameter	1.65"
Type of installations	modular - customizable 1"
Packaging - Weight	No. 1 0.35 ft³ lb 12

Type of seals	NBR
Air motor	aluminum
Suction tube	carbon steel
Bung adapter	38042-55
Air inlet connection	1/4" NPT (f)
Fluid outlet connection	1/2" NPT (f)
Air working pressure	90 - 120 psi
Noise level	81 dB
Deliverable oil temperature	14 - 122 °F
Max. deliverable oil viscosity	130 SAE
Cycles per gallon	102.3
Max. air consumption 120 psi	26 cfm
Suction tube length	29"
Suction tube external diameter	1.65"
Type of installations	suitable for drum 16 gal
Packaging - Weight	No. 1 0.49 ft³ lb 14

Type of seals	NBR
Air motor	aluminum
Suction tube	carbon steel
Bung adapter	38042-55
Air inlet connection	1/4" NPT (f)
Fluid outlet connection	1/2" NPT (f)
Air working pressure	90 - 120 psi
Noise level	81 dB
Deliverable oil temperature	14 - 122 °F
Max. deliverable oil viscosity	130 SAE
Cycles per gallon	102.3
Max. air consumption 120 psi	26 cfm
Suction tube length	37"
Suction tube external diameter	1.65"
Type of installations	suitable for drum 55 gal
Packaging - Weight	No. 1 0.60 ft³ lb 16

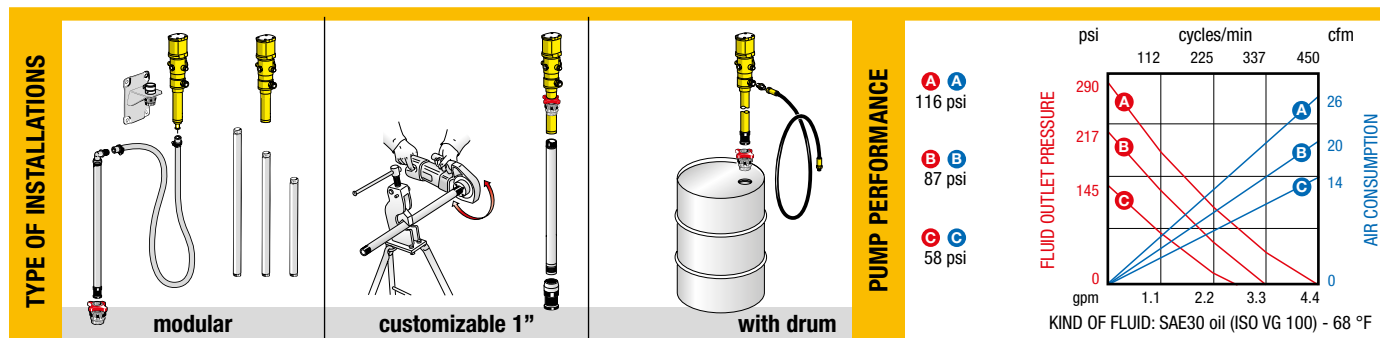



3:1 MOBILE LUBE PACKAGES (55 gal)

Dolly-mounted oil dispenser kits with digital metered valve and 3:1 pumps.

Available with or without hose reel. The ideal combinations for dispensing oil in any workplace.

The very easy to maneuver dolly is equipped with a drum (55 gal) clamping device, side support for the control handle.

The kit equipped with the dolly model P/N 80210-55 also has a rear wheel brake.



P/N 35198-55

Mobile lube kit for drums of 55 gal with:
 ■ pump 3:1 - 5.30 gpm
 ■ hose reel

P/N 35199-55

Mobile lube kit for drums of 55 gal with:
 ■ pump 3:1 - 4.40 gpm
 ■ hose reel

P/N 35219-55

Mobile lube kit for drums of 55 gal with:
 ■ pump 3:1 - 5.30 gpm

P/N 35220-55

Mobile lube kit for drums of 55 gal with:
 ■ pump 3:1 - 4.40 gpm

Pump 3:1	35094-55
Heavy duty dolly	80210-55 (with brake)
Hose reel 1/2" - 35'	8430.401-55
Bung adapter	38046-55
Control valve with digital meter	37739-55
Hose 1/2"	996.302-55 (7')
Packaging - Weight	No. 1 16.0 ft³ lb 120

Pump 3:1	35567-55
Heavy duty dolly	80210-55 (with brake)
Hose reel 1/2" - 35'	8430.401-55
Bung adapter	38042-55
Control valve with digital meter	37739-55
Hose 1/2"	996.302-55 (7')
Packaging - Weight	No. 1 16.0 ft³ lb 118

Pump 3:1	35094-55
Heavy duty dolly	80200-55 (no brake)
Hose reel 1/2" - 35'	-
Bung adapter	38046-55
Control valve with digital meter	37739-55
Hose 1/2"	996.304-55 (13')
Packaging - Weight	No. 1 6.0 ft³ lb 70

Pump 3:1	35567-55
Heavy duty dolly	80200-55 (no brake)
Hose reel 1/2" - 35'	-
Bung adapter	38042-55
Control valve with digital meter	37739-55
Hose 1/2"	996.304-55 (13')
Packaging - Weight	No. 1 6.0 ft³ lb 73

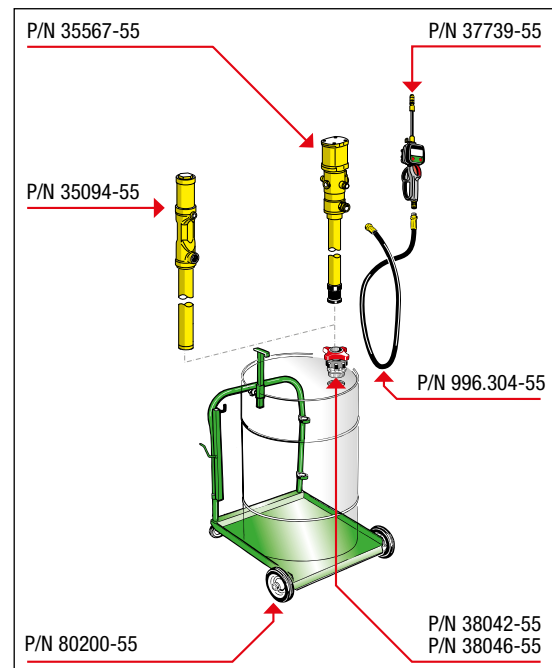
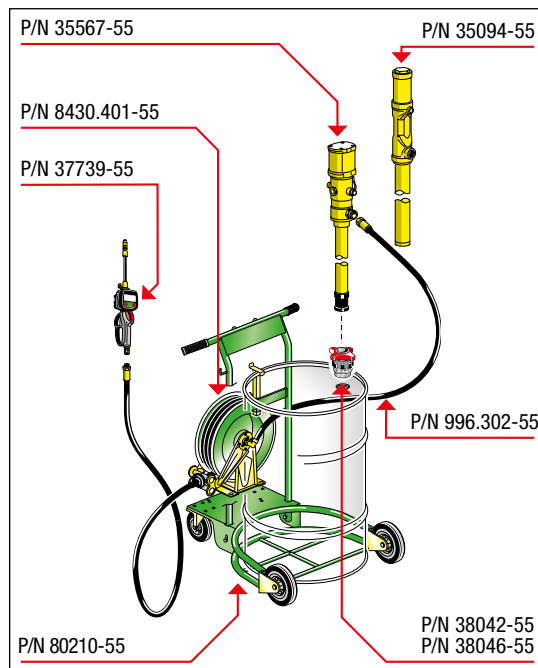



3:1 MOBILE LUBE PACKAGES (16 gal)

Dolly-mounted oil dispenser kits.

The ideal combinations for dispensing oil in any workplace.

The compact dolly has 2 fixed wheels and 2 castors that make it very easy to handle.

It is equipped with a pump support and is suitable for holding various types of containers (max 16 gal).



P/N 35250-55

Mobile lube kit for drums of 16 gal with:
■ pump 3:1 - 4.40 gpm

Pump 3:1	35564-55
Dolly	80050-55
Drum cover	-
Bung adapter	38042-55
Control valve with digital meter	37739-55
Hose 1/2" - 13'	996.304-55
Packaging - Weight	No. 1 4.9 ft ³ lb 44



P/N 35253-55

Mobile lube kit for drums of 16 gal with:
■ pump 3:1 - 4.40 gpm
■ drum cover

35564-55
80050-55
65138-55
38042-55
37739-55
996.304-55
No. 1 4.9 ft ³ lb 51



P/N 35254-55

Lube kit for drums of 16 gal with:
■ pump 3:1 - 4.40 gpm
■ drum cover

35564-55
-
65138-55
38042-55
37739-55
996.304-55
No. 1 4.9 ft ³ lb 31

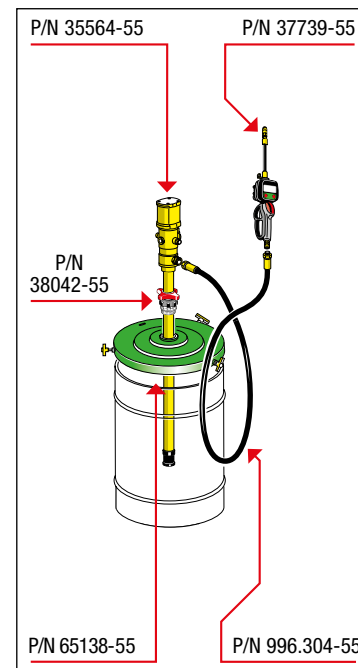
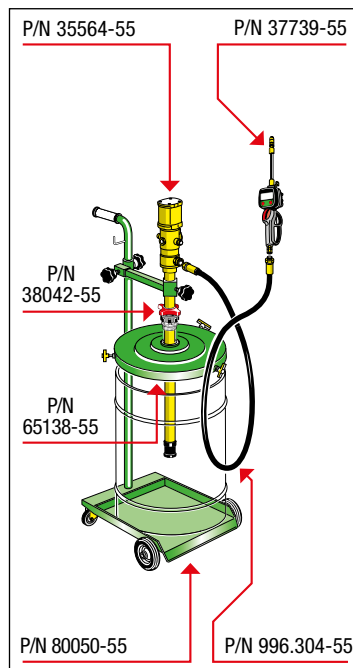
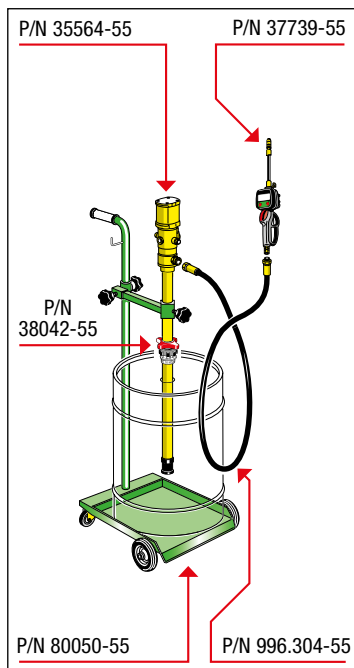



3:1 MOBILE LUBE PACKAGES (16 gal)



Applied
Lubrication
Technology Inc.

Dolly-mounted oil dispenser kits.

The ideal combination for dispensing oil in any workplace. The compact dolly has 2 fixed wheels and 2 castors that make it very easy to handle. It is equipped with a pump support and is suitable for holding various types of containers (16 gal).



P/N 35260-55

Mobile lube kit for drums of 16 gal with:
■ pump 3:1 - 5.30 gpm

P/N 35263-55

Mobile lube kit for drums of 16 gal with:
■ pump 3:1 - 5.30 gpm
■ drum cover

P/N 35264-55

Lube kit for drums of 16 gal with:
■ pump 3:1 - 5.30 gpm
■ drum cover

Pump 3:1	35076-55
Dolly	80050-55
Drum cover	-
Bung adapter	38046-55
Control valve with digital meter	37739-55
Hose 1/2" - 13'	996.304-55
Packaging - Weight	No. 1 4.9 ft ³ lb 44

35076-55
80050-55
65138-55
38046-55
37739-55
996.304-55
No. 1 4.9 ft ³ lb 51

35076-55
-
65138-55
38046-55
37739-55
996.304-55
No. 1 4.9 ft ³ lb 31

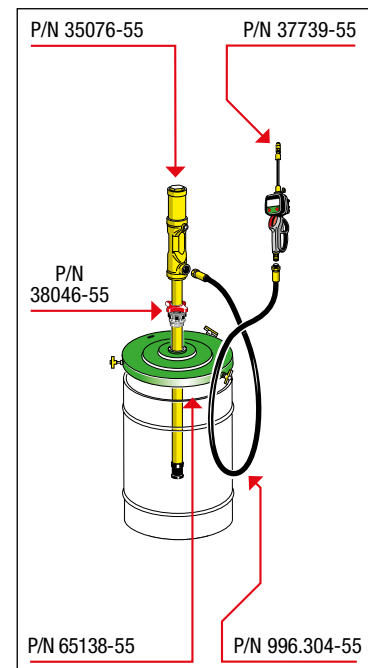
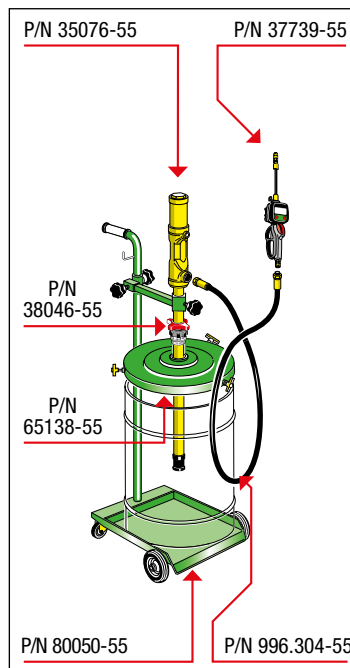
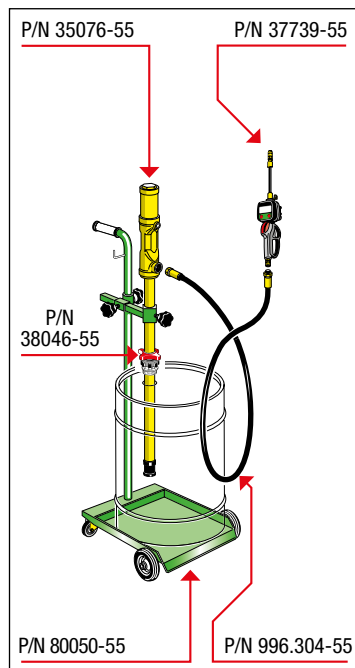



3:1 MODULAR OIL KITS



Applied
Lubrication
Technology Inc.

Systems for oil
dispensing with
pump installed on
wall or on the tank.
Ideal for distribution
from storage zones.



Note: the tank is
not part of the kit

P/N 35285-55

Modular wall-mounted kit, for dispensing
from trade drums 55 gal with:

- pump 3:1 - 4.40 gpm

Pump 3:1	35561-55
Hose reel 1/2" - 33'	-
Bung adapter	38042-55
Control valve with digital meter	-
Extensions ø 1.3" - 37.8"	-
Flexible suction tube ø 1-1/4"	38026-55
Rigid suction tube	38027-55
Pump support bracket	38043-55
Hose connector	38081-55
Packaging - Weight	No. 1 1.02 ft³ lb 25

P/N 36613-55

Dispensing kit for oil and allied products with:

- pump 3:1 - 4.40 gpm inserted centrally in the tank
- open hose reel

35561-55
8430.401-55
38042-55
37739-55
10/23-55
-
-
36602-55
-
No. 1 12.0 ft³ lb 117

